

- Legend**
-  Signed Detour Route
  -  Road Open to Traffic
  -  Road Closed to Traffic

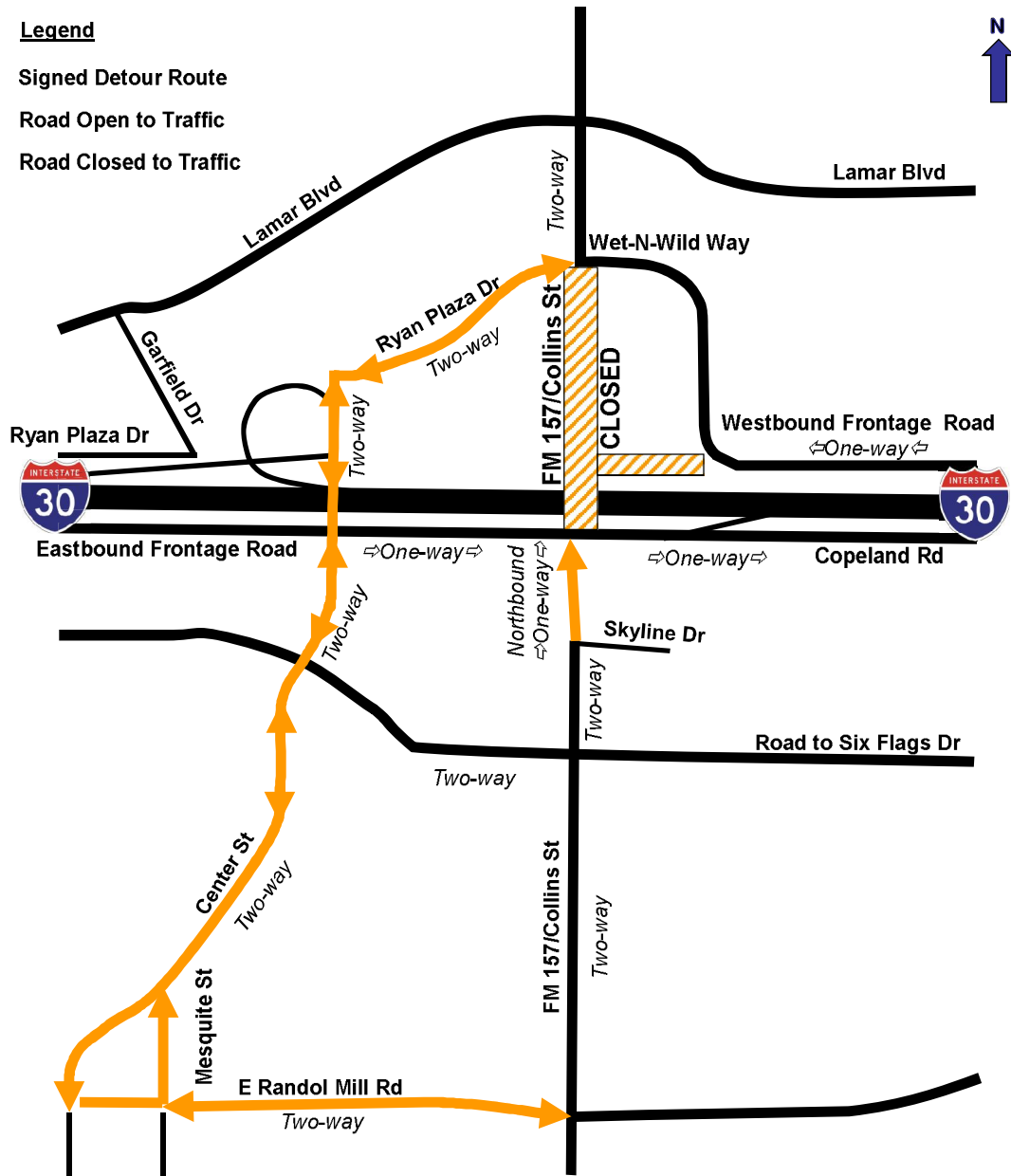

## FM 157/COLLINS STREET DETOUR

### TRAFFIC CONTROL PLAN

**START:** July 2009  
**END:** Fall 2009

**WHY:** Expedite mobility on FM 157/Collins Street between Lamar Boulevard and Skyline Drive nearly 4 months ahead of schedule with completion this fall.

**WHAT: Northbound FM 157/Collins Street Detour Route**  
 Northbound FM 157/Collins Street through traffic will be detoured to Center Street across the bridge over I-30 to Ryan Plaza Drive east to FM 157/Collins Street.

FM 157/Collins Street north of Road to Six Flags Drive to Skyline Drive will remain in two-way operation with full access to both Skyline Drive and the Lincoln Square Mall entrance.

**Southbound FM 157/Collins Street Detour Route**  
 Southbound through traffic will be detoured at Ryan Plaza Drive west to Center Street across the new I-30/Center Street bridge. Motorists then may use either Road to Six Flags Drive or Randol Mill Road to access FM 157/Collins Street to the east.

**Westbound Frontage Road to FM 157/Collins Street**  
 The westbound frontage road will be directed along Wet-N-Wild Way to the intersection with FM 157/Collins Street and Ryan Plaza Drive. Motorists destined for southbound FM 157/Collins Street will continue west onto Ryan Plaza Drive following the detour route.

